

# EL System Quick Start Guide

Model UUU

## Tools Needed

- Adjustable wrench
- 1/8 inch slotted screwdriver
- Philips head screwdriver
- Wire strippers

## Step 1 Board Connections

Make the following electrical connections:

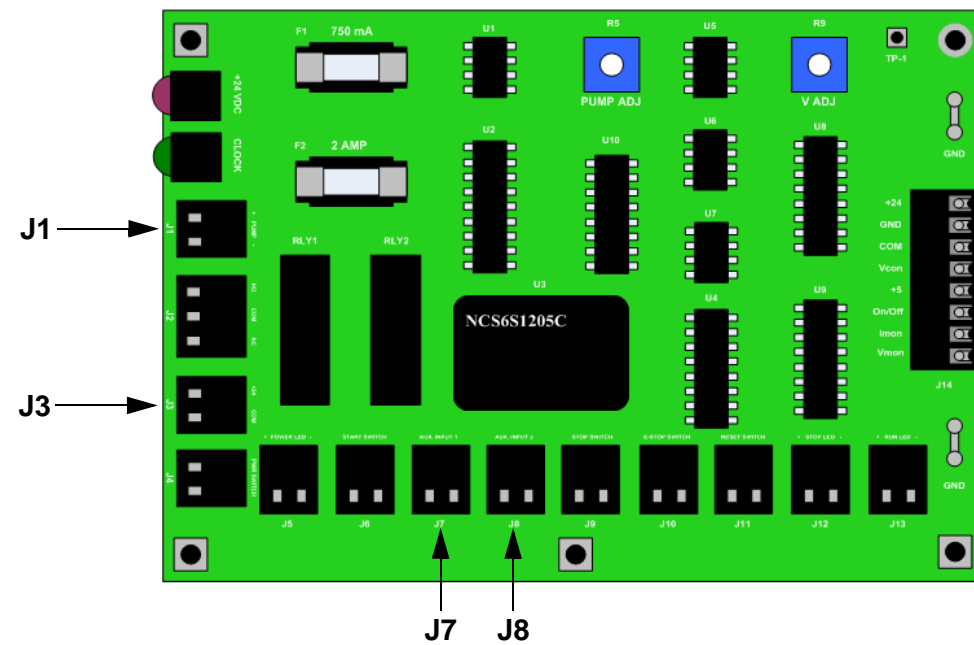

- J1 terminal (solenoid cable) and confirm polarity
- J3 terminal (24 VDC Input) and confirm polarity
- J7 terminal (Low Oil Switch)
- J8 terminal (Air Pressure Switch)

**NOTE:** Use a 1/8 inch slotted screwdriver to press down in the slot on top of the terminal block so that you can push in the cable wire into the corresponding side slot.

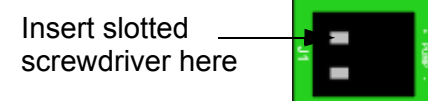

## Step 2 Grounding and Bonding

1. Ground and bond ring terminals in the terminal block.

**NOTE:** All grounding and bonding need to be ring terminals and grounded to an earth ground.

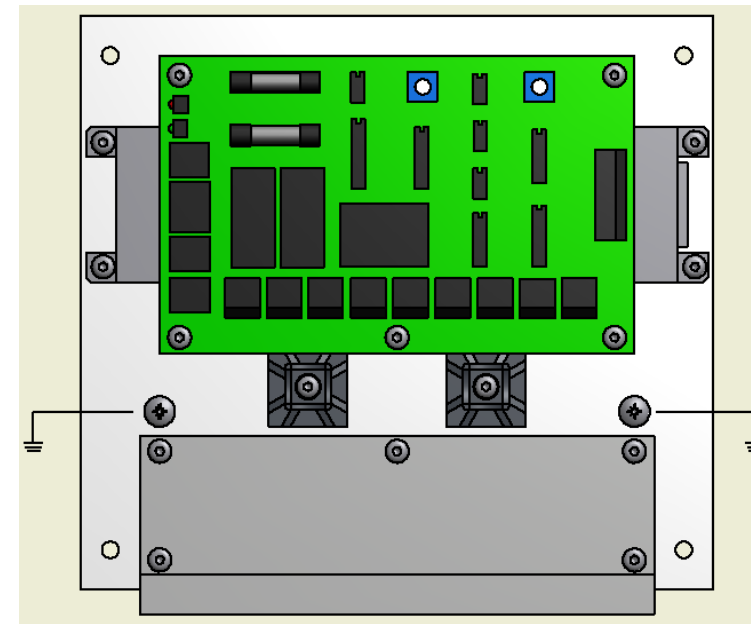

2. Bond the equipment being lubricated to the controller's bonding lug.

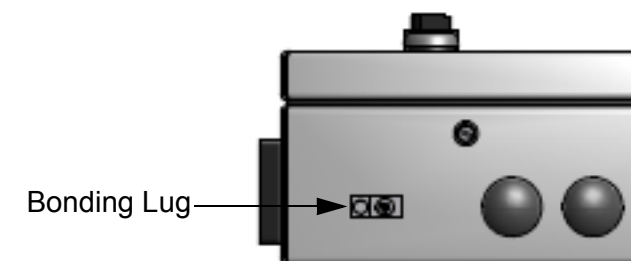

## Step 3 Nozzle Connections

1. Connect the nozzle.

---

**NOTE:** The nozzle must be located 1/2 inch to 3/4 inch (12.7 mm to 19 mm) directly above the lubrication point.

---

2. Connect the high voltage cable by:
  - a. Sliding the wire end of the high voltage cable through the cable entry grommet on the outside of the controller.

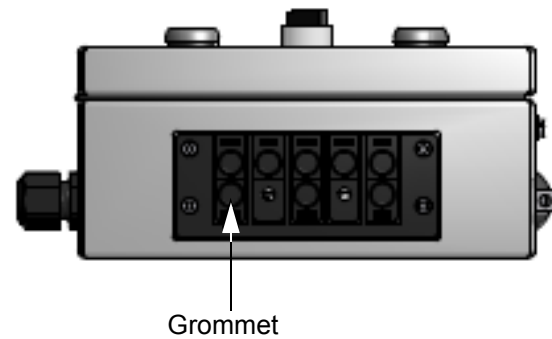

- b. Connecting the cables to the high voltage terminal block.
- c. Attaching a wire tie around the cable and one of the cable entry grommet tab.
- d. Connecting the boot shaped end of the high voltage cable to the nozzle, making sure it “clicks” into place.
- e. Running 1/4 inch tubing from the pump outlet to the nozzle liquid inlet.

## Step 4 Air Connections

1. Connect the air inlet to the 1/8 inch NPT female on the filter.

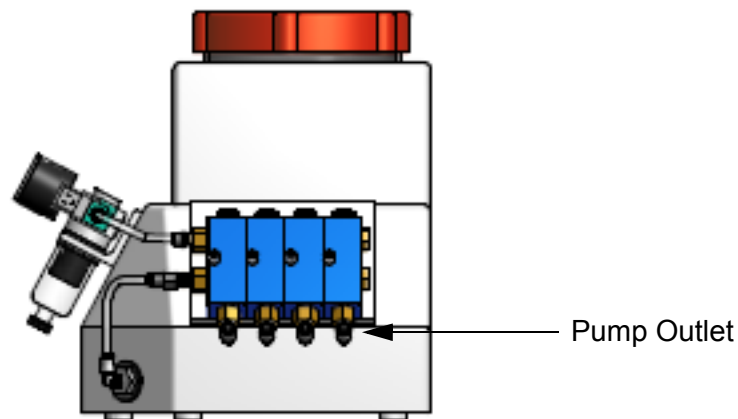

2. Adjust the regulator by removing the clear cap and by turning adjustment screw to 40 psi (2.75 bar). Reinstall the clear cap when complete.

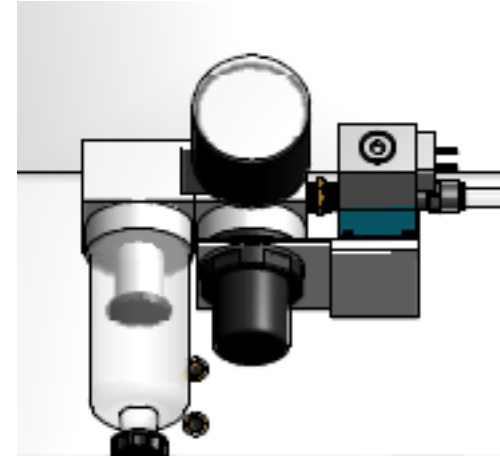

## Step 5 Fill Reservoir

Add oil to the reservoir.

## Powering On the System

1. Turn power selector switch to ON (green button illuminates).
2. To speed up oil delivery, turn pump adjustment screw counter-clockwise until it stops.
3. In the control box, turn pump potentiometer clockwise until it stops.
4. Run pump on Full Open until oil reaches the nozzle.
5. Set pump adjustment screw to desired position (1 1/2 to 2 turns) for desired flow weight.



**WARNING:** When unit is on, do not touch any high voltage connections including the high voltage cable, terminal block, and nozzle.

**CAUTION:** Do not power unit on without the terminal block cover in place.

## Customer Support

ABC Company  
P.O. Box 123  
USA  
XXX..XXX.XXXX